

EG - GRUNDRISS - PFARRWEG - HAUS

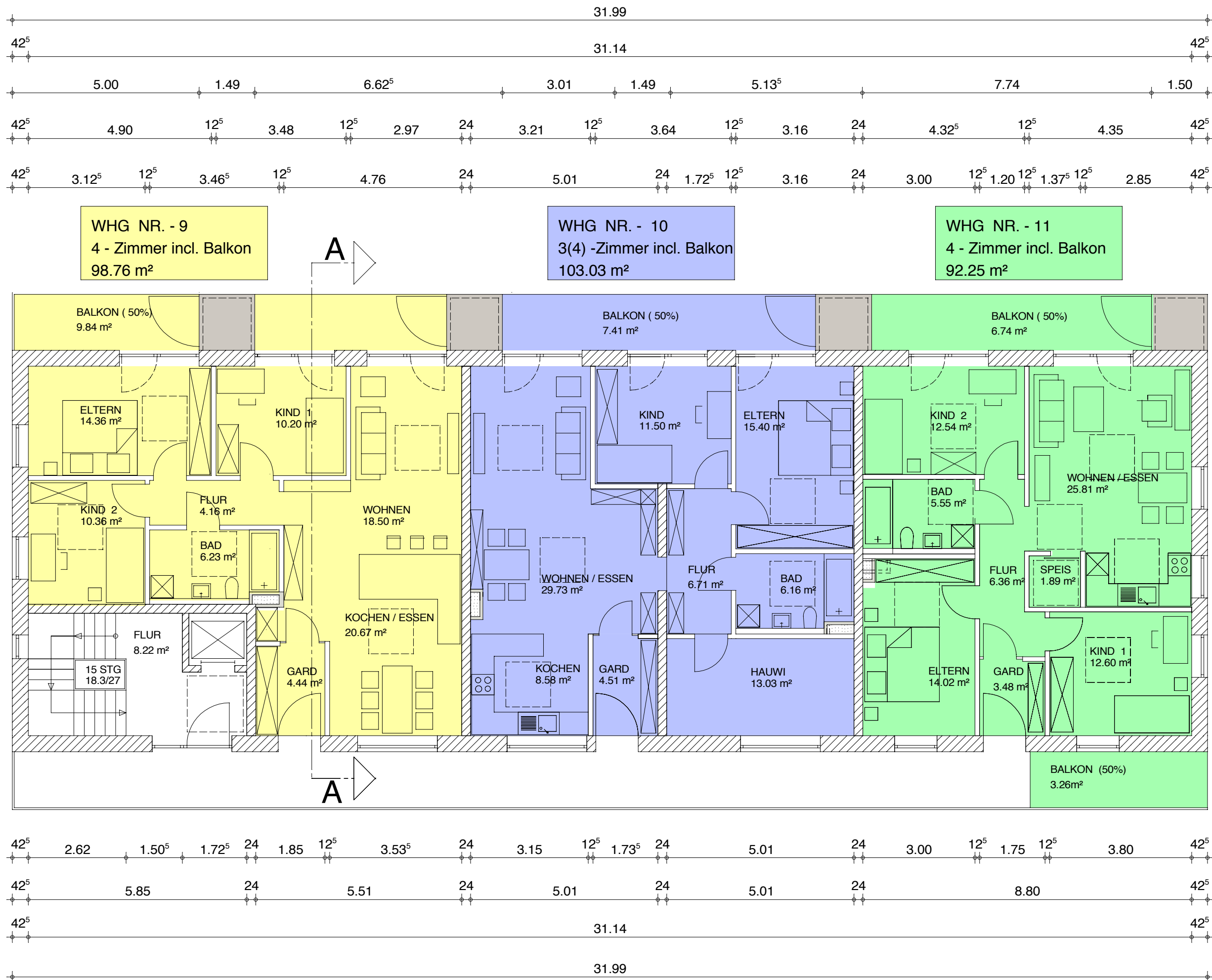

OG - GRUNDRISS - PFARRWEG - HAUS

WHG NR. - 1
3 - Zimmer incl. Terrasse
73.72 m²

z. B. Grenzmauer mit Wild

Halböffentlicher Bereich mit Gemeinschaftsbeete

Gemeinschaftsplatz
(Grillen, Spielen,
Sitzen...)

EG-GRUNDRISS - STIEGLER - HAUS

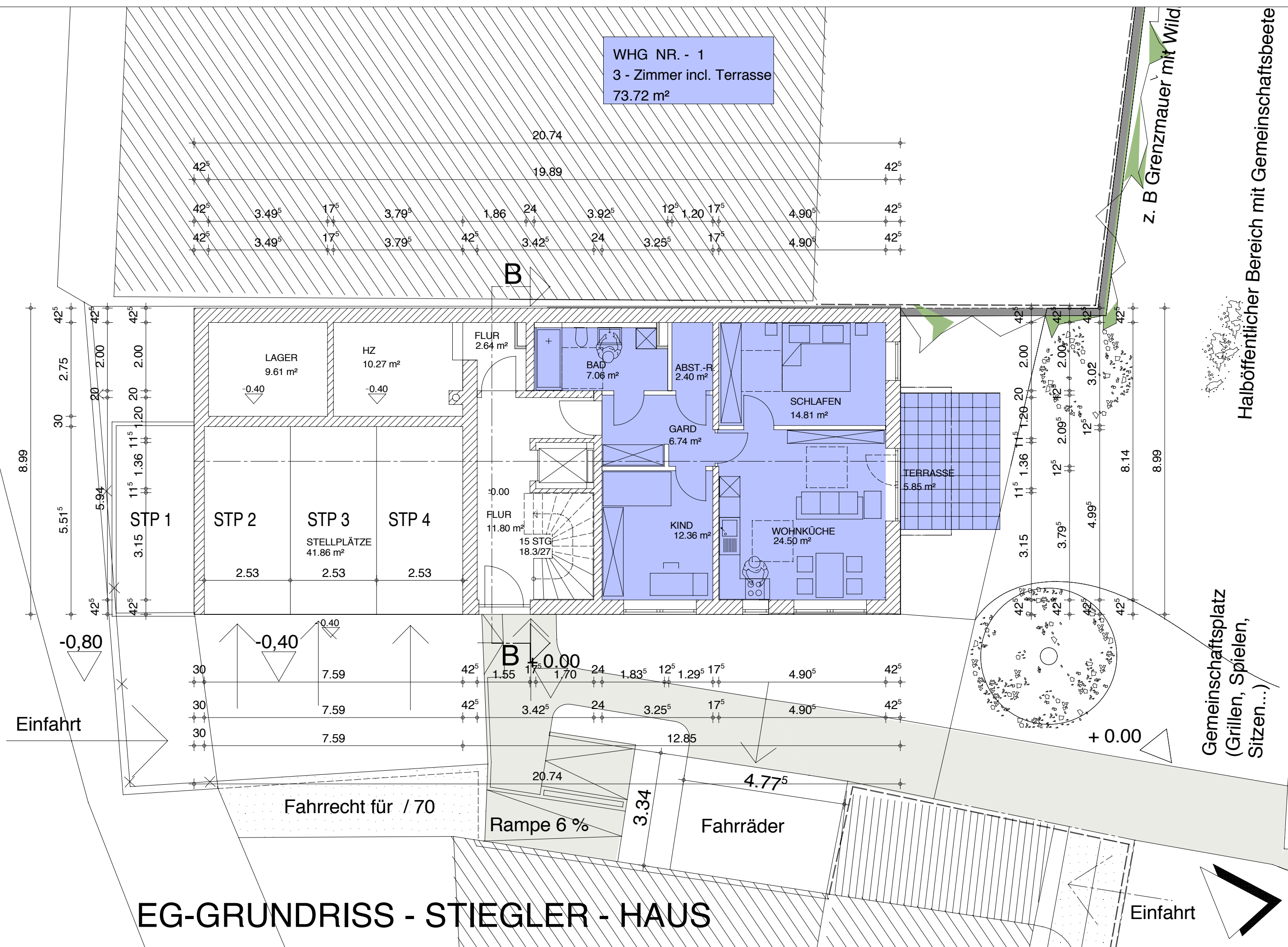

WHG NR. - 3
2 - Zimmer incl. Winterg.
58.94 m²

WHG NR. - 2
3 - Zimmer incl. Balkon
71.12 m²

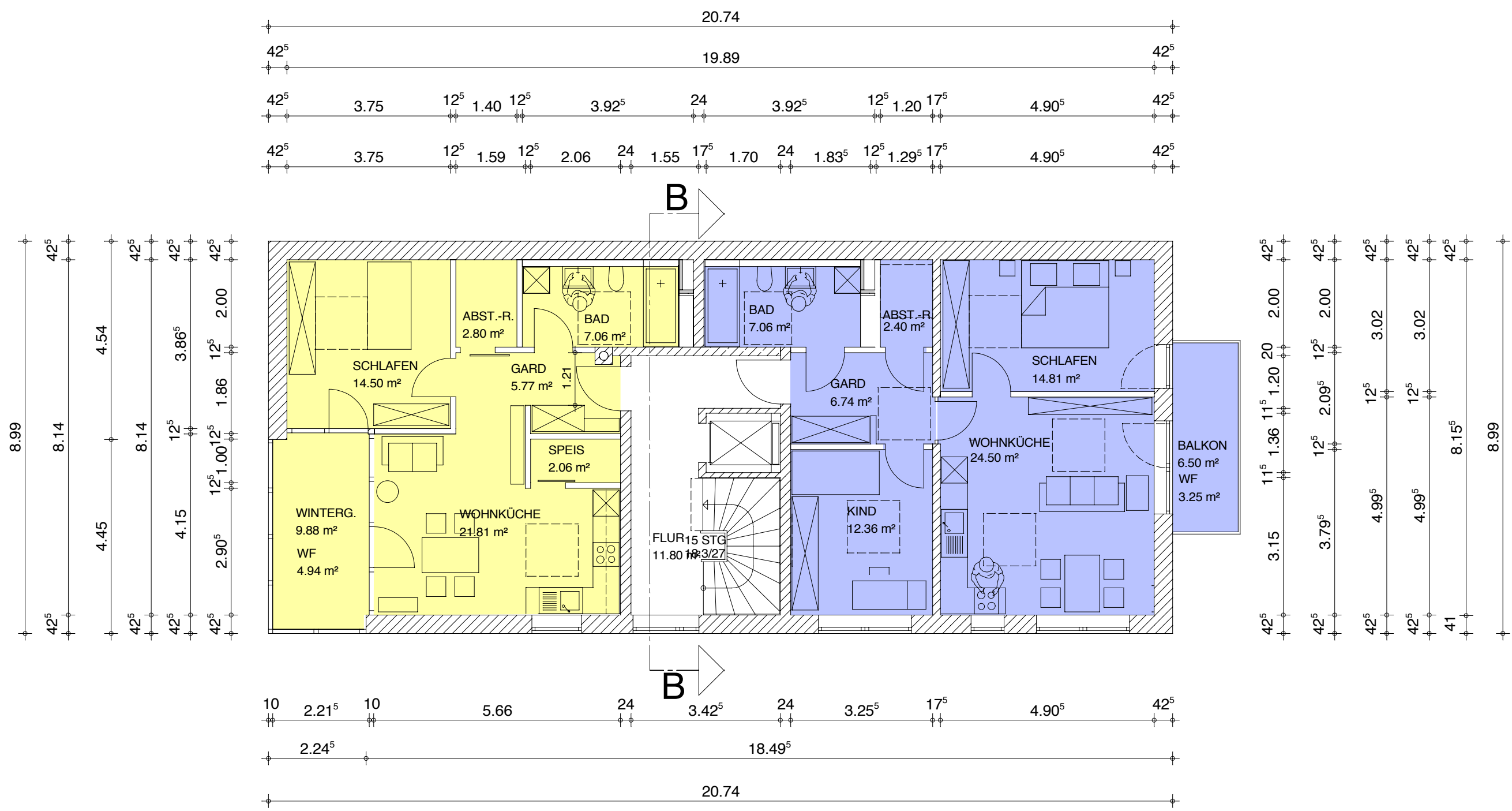

OG - GRUNDRISS - STIEGLER - HAUS

WHG NR. - 4
 4 - Zimmer incl. Balkon
 93.01 m²

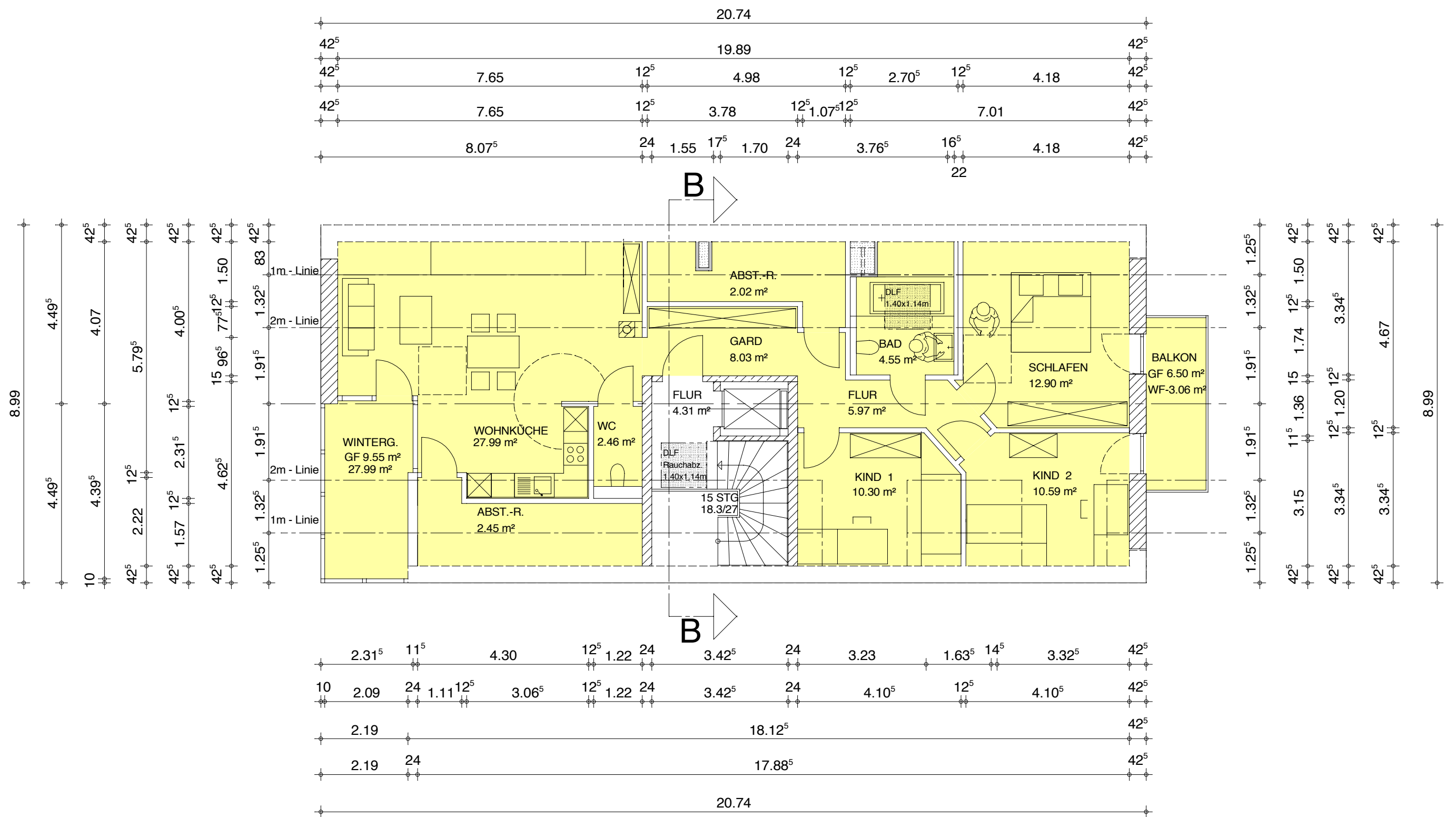

DG - GRUNDRISS - STIEGLER - HAUS

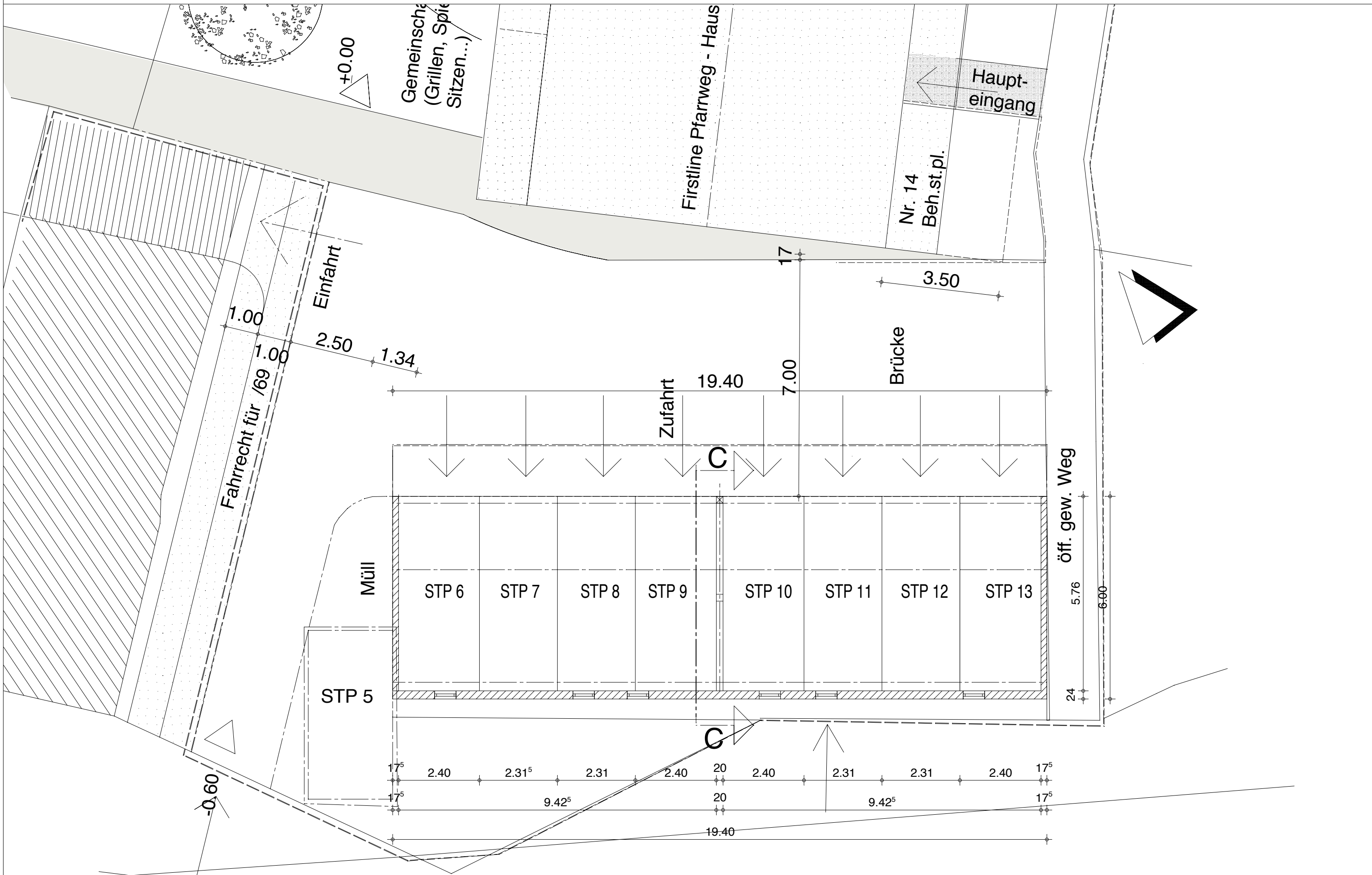

EG - GRUNDRISS - PARKSTADL

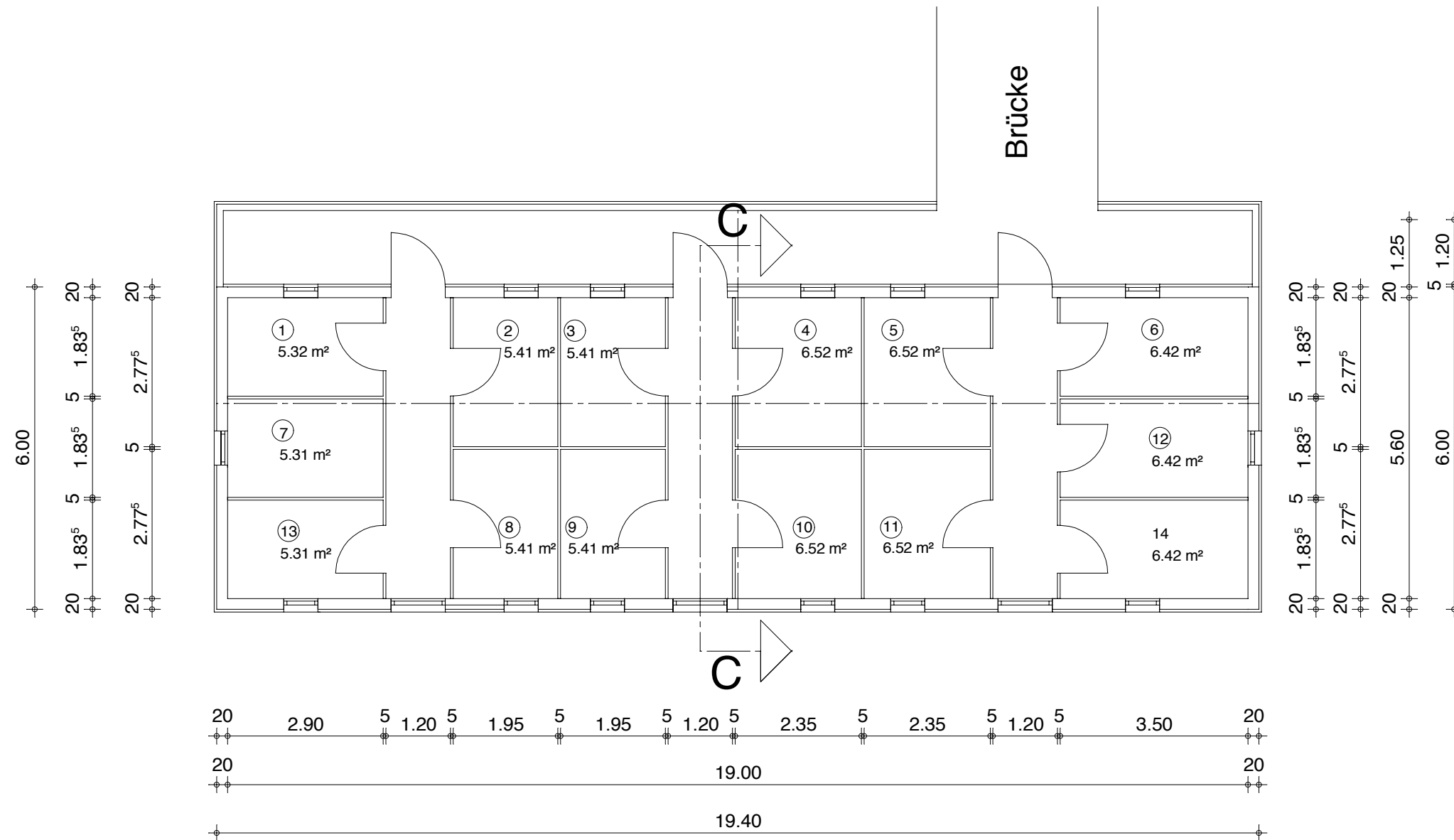

OG - GRUNDRISS - PARKSTADL